

DTP T HWP 4K 231 D

DTP TRANSMITTER FOR
HDMI – DECORATOR-STYLE
WALLPLATE

DTP
SYSTEMS

4K UHD



The Extron DTP T HWP 4K 231 D is a single-gang decorator-style transmitter for sending HDMI, analog audio, and bidirectional control signals up to 230 feet (70 meters) over a shielded CATx cable to Extron DTP™-enabled products. It is designed for efficient use within configurable rooms and environments offering limited space. The HDCP-compliant transmitter features a convenient one-gang form factor that offers maximum placement flexibility.

- ▶ Transmits HDMI plus control and analog audio up to 230 feet (70 meters) over a shielded CATx cable
- ▶ Supports computer and video resolutions up to 4K, including 1080p/60 Deep Color
- ▶ Extron XTP DTP 24 shielded twisted pair cable is strongly recommended for optimal performance
- ▶ DTP™ output is compatible with HDBaseT-enabled devices
- ▶ Accepts additional analog stereo audio signals
- ▶ Bidirectional RS-232 and IR pass-through for AV device control
- ▶ Remote power capability
- ▶ Supported HDMI specification features include data rates up to 10.2 Gbps, Deep Color up to 12-bit, 3D, HD lossless audio formats, and CEC pass-through
- ▶ Supports EDID and HDCP transmission
- ▶ Compatible with all DTP 230 Series receivers and DTP-enabled products
- ▶ Mounts in an included single-gang decorator-style wallplate
- ▶ Highly reliable, energy-efficient external universal power supply included



Extron Electronics
INTERFACING, SWITCHING AND CONTROL

DESCRIPTION

The Extron **DTP T HWP 4K 231 D** is a single-gang, decorator-style transmitter for sending HDMI, audio, and bidirectional RS-232 and IR signals up to 230 feet (70 meters) over a shielded CATx cable to Extron DTP-enabled products. The one-gang form factor provides maximum space efficiency in wall mount, floor box, and furniture mount applications. The DTP T HWP 4K 231 D accepts analog stereo audio signals for simultaneous transmission over the same shielded twisted pair cable. It supports video signals at resolutions up to 4K, including 1080p/60 Deep Color. The transmitter features remote power capability, bidirectional RS-232 and IR pass-through for remote AV device control, and an HDBaseT output mode for compatibility with any HDBaseT-enabled display. The single-gang wall-mountable design of the DTP T HWP 4K 231 D provides the convenience of placing input connections precisely where they are needed.

The DTP T HWP 4K 231 D enables the reliable transmission of HDMI signals, supporting Deep Color up to 12-bit, CEC pass-through, and embedded HD lossless audio formats. DDC communication of EDID and HDCP is continuously maintained between a source and display, ensuring direct compatibility and optimal signal transmission between devices. For added installation flexibility, the transmitter can be remotely powered over the shielded twisted pair cable by a DTP-enabled product. The DTP T HWP 4K 231 D can be integrated with an Extron DTP CrossPoint® 84 Presentation Matrix Switcher, or other DTP-enabled products to support sources at remote locations.

APPLICATION DIAGRAM

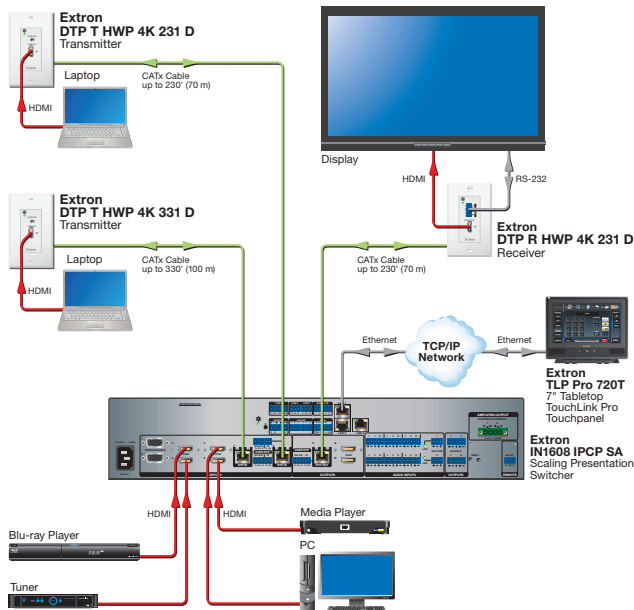

SPECIFICATIONS

TRUE 4K SPECIFICATION

Max 4K Capabilities		
Resolution and Refresh Rate	Chroma Sampling	Max Bit Depth per Color
4096 x 2160 at 30 Hz 3840 x 2160 at 30 Hz	4:4:4	8 bit
4096 x 2160 at 60 Hz 3840 x 2160 at 60 Hz	4:2:0	

Frame rate ¹	24, 25, 30, 50, or 60 fps
Chroma sampling ¹	4:4:4, 4:2:2, or 4:2:0
Color bit depth ¹	8 bits per color
Signal type	HDMI 1.4, HDCP 2.2
Max. video data rate	10.2 Gbps (3.4 Gbps per color)

NOTE: ¹Subject to the maximum data rate limit. Use our calculator at www.extron.com/4Kdata to determine video parameters supported by this data rate.

INTERCONNECTION BETWEEN TRANSMITTER AND RECEIVER

Connectors	1 female RJ-45 per unit for 1 cable connecting the transmitter and receiver
DTP signal	
Signal transmission distance	
1080p @ 60 Hz	Up to 230' (70 m) using shielded twisted pair (STP) cable or XTP DTP 24 cable
2560x1600 @ 60 Hz	Up to 130' (40 m) using STP cable or XTP DTP 24 cable
4K/UHD @ 30 and 60 Hz	Up to 130' (40 m) using STP cable or XTP DTP 24 cable
Cable requirements	Solid conductor, 24 AWG or better
Cable recommendations	400 MHz bandwidth STP cable

NOTE: Extron XTP DTP 24 shielded twisted pair cable is strongly recommended for optimal performance.

Output mode signaling:

DTP: HDMI with embedded audio, analog audio, RS-232 and IR, and remote power

HDBaseT: HDMI with embedded audio plus RS-232 and IR

AUDIO INPUT

Number/signal type	1 stereo (2 channel), unbalanced
---------------------------	----------------------------------

NOTE: Analog audio is not embedded onto the digital video signal. Analog audio and digital embedded audio are transmitted simultaneously and output on the receiver on two different connectors.

Connectors	(1) 3.5 mm stereo jack, 2 channel; tip (L); ring (R); sleeve (ground)
-------------------	---

GENERAL

Power supply	External Input: 100-240 VAC, 50-60 Hz Output: 12 VDC, 1 A, 12 watts
Enclosure dimensions	
Device	2.8" H x 1.7" W x 1.9" D (7.1 cm H x 4.3 cm W x 4.8 cm D)
Regulatory compliance	
Safety	c-UL, UL
EMI/EMC	AN/NZS, CE**, C-tick, FCC Class A**, ICES

NOTE: Shipping dimensions and weights are available at www.extron.com.

Model	Version Description	Part number
DTP T HWP 4K 231 D	HDMI Decorator-Style Tx, Black - 230 feet (70 m)	60-1421-12
DTP T HWP 4K 231 D	HDMI Decorator-Style Tx, White - 230 feet (70 m)	60-1421-13

For complete specifications, please go to www.extron.com
Specifications are subject to change without notice.

WORLDWIDE SALES OFFICES

Anaheim • Raleigh • Silicon Valley • Dallas • New York • Washington, DC • Toronto • Mexico City • Paris • London • Frankfurt
Madrid • Stockholm • Amersfoort • Moscow • Dubai • Johannesburg • Tel Aviv • Sydney • Melbourne
New Delhi • Bangalore • Singapore • Seoul • Shanghai • Beijing • Hong Kong • Tokyo

www.extron.com