

# DTP T HWP 4K 331 D

LONG DISTANCE DTP TRANSMITTER FOR HDMI – DECORATOR-STYLE WALLPLATE

**DTP**  
SYSTEMS

**4K UHD**



The Extron DTP T HWP 4K 331 D is a single-gang decorator-style transmitter for sending HDMI, analog audio, and bidirectional control signals up to 330 feet (100 meters) over a shielded CATx cable to Extron DTP™ 330-enabled products. It is designed for efficient use within configurable rooms and environments offering limited space. The HDCP-compliant transmitter features a convenient one-gang form factor that offers maximum placement flexibility.

- ▶ Transmits HDMI plus control and analog audio up to 330 feet (100 meters) over a shielded CATx cable
- ▶ Supports computer and video resolutions up to 4K, including 1080p/60 Deep Color
- ▶ Extron XTP DTP 24 shielded twisted pair cable is strongly recommended for optimal performance
- ▶ DTP™ output is compatible with HDBaseT-enabled devices
- ▶ Accepts additional analog stereo audio signals
- ▶ Bidirectional RS-232 and IR pass-through for AV device control
- ▶ Remote power capability
- ▶ Supported HDMI specification features include data rates up to 10.2 Gbps, Deep Color up to 12-bit, 3D, HD lossless audio formats, and CEC pass-through
- ▶ Supports EDID and HDCP transmission
- ▶ Compatible with all DTP 330 Series receivers and DTP 330-enabled products
- ▶ Mounts in an included single-gang decorator-style wallplate
- ▶ Highly reliable, energy-efficient external universal power supply included



**Extron Electronics**  
INTERFACING, SWITCHING AND CONTROL

## DESCRIPTION

The Extron **DTP T HWP 4K 331 D** is a single-gang, decorator-style, long distance transmitter for sending HDMI, audio, and bidirectional RS-232 and IR signals up to 330 feet (100 meters) over a shielded CATx cable to Extron DTP 330-enabled products. The one-gang form factor provides maximum space efficiency in wall mount, floor box, and furniture mount applications. The DTP T HWP 4K 331 D accepts analog stereo audio signals for simultaneous transmission over the same shielded twisted pair cable. It supports video signals at resolutions up to 4K, including 1080p/60 Deep Color. The transmitter features remote power capability, bidirectional RS-232 and IR pass-through for remote AV device control, and an HDBaseT output mode for compatibility with any HDBaseT-enabled display. The single-gang wall-mountable design of the DTP T HWP 4K 331 D provides the convenience of placing input connections precisely where they are needed.

The DTP T HWP 4K 331 D enables the reliable transmission of HDMI signals, supporting Deep Color up to 12-bit, CEC pass-through, and embedded HD lossless audio formats. DDC communication of EDID and HDCP is continuously maintained between a source and display, ensuring direct compatibility and optimal signal transmission between devices. For added installation flexibility, the transmitter can be remotely powered over the shielded twisted pair cable by a DTP 330-enabled product. The DTP T HWP 4K 331 D can be integrated with an Extron DTP CrossPoint® 84 Presentation Matrix Switcher, or other DTP 330-enabled products to support sources at remote locations.

## APPLICATION DIAGRAM

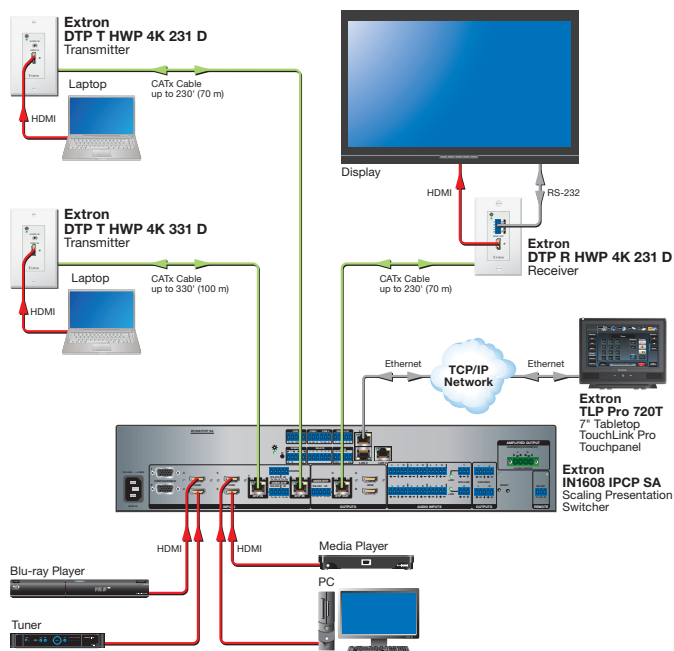

## SPECIFICATIONS

### TRUE 4K SPECIFICATION

Max 4K Capabilities		
Resolution and Refresh Rate	Chroma Sampling	Max Bit Depth per Color
4096 x 2160 at 30 Hz 3840 x 2160 at 30 Hz	4:4:4	8 bit
4096 x 2160 at 60 Hz 3840 x 2160 at 60 Hz	4:2:0	
Frame rate <sup>1</sup>	24, 25, 30, 50, or 60 fps	
Chroma sampling <sup>1</sup>	4:4:4, 4:2:2, or 4:2:0	
Color bit depth <sup>1</sup>	8 bits per color	
Signal type	HDMI 1.4, HDCP 2.2	
Max. video data rate	10.2 Gbps (3.4 Gbps per color)	
<b>NOTE:</b> <sup>1</sup> Subject to the maximum data rate limit. Use our calculator at <a href="http://www.extron.com/4Kdata">www.extron.com/4Kdata</a> to determine video parameters supported by this data rate.		

### INTERCONNECTION BETWEEN TRANSMITTER AND RECEIVER

Connectors	1 female RJ-45 per unit for 1 cable connecting the transmitter and receiver
DTP signal	
Signal transmission distance	
1080p @ 60 Hz	Up to 330' (100 m) using shielded twisted pair (STP) cable or XTP DTP 24 cable
2560x1600 @ 60 Hz	Up to 330' (100 m) using STP cable or XTP DTP 24 cable
4K/UHD @ 30 and 60 Hz	Up to 330' (100 m) using STP cable or XTP DTP 24 cable
Cable requirements	Solid conductor, 24 AWG or better
Cable recommendations	400 MHz bandwidth STP cable
<b>NOTE:</b> Extron XTP DTP 24 shielded twisted pair cable is strongly recommended for optimal performance.	
<b>NOTE:</b>	
Output mode signaling:	
DTP: HDMI with embedded audio, analog audio, RS-232 and IR, and remote power	
HDBaseT: HDMI with embedded audio plus RS-232 and IR	

### AUDIO INPUT

Number/signal type	1 stereo (2 channel), unbalanced
<b>NOTE:</b> Analog audio is not embedded onto the digital video signal. Analog audio and digital embedded audio are transmitted simultaneously and output on the receiver on two different connectors.	
Connectors	(1) 3.5 mm stereo jack, 2 channel; tip (L); ring (R); sleeve (ground)

### GENERAL

Power supply	External
	Input: 100-240 VAC, 50-60 Hz
	Output: 12 VDC, 1 A, 12 watts
Enclosure dimensions	
Device	2.8" H x 1.7" W x 1.9" D (7.1 cm H x 4.3 cm W x 4.8 cm D)
<b>NOTE:</b> Shipping dimensions and weights are available at <a href="http://www.extron.com">www.extron.com</a> .	

Model	Version Description	Part number
DTP T HWP 4K 331 D	HDMI Decorator-Style Tx, Black - 330 feet (100 m)	60-1421-52
DTP T HWP 4K 331 D	HDMI Decorator-Style Tx, White - 330 feet (100 m)	60-1421-53

For complete specifications, please go to [www.extron.com](http://www.extron.com)  
Specifications are subject to change without notice.

### WORLDWIDE SALES OFFICES

Anaheim • Raleigh • Silicon Valley • Dallas • New York • Washington, DC • Toronto • Mexico City • Paris • London • Frankfurt  
Madrid • Stockholm • Amersfoort • Moscow • Dubai • Johannesburg • Tel Aviv • Sydney • Melbourne  
New Delhi • Bangalore • Singapore • Seoul • Shanghai • Beijing • Hong Kong • Tokyo

[www.extron.com](http://www.extron.com)